

# Weld on Caps

## STANDARD WEIGHT

Inches / Pounds

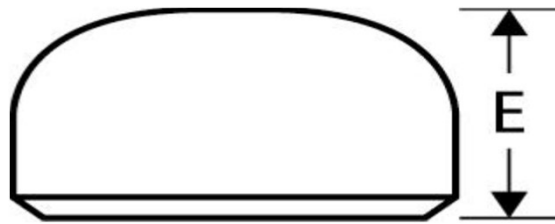

Part #	Nominal Pipe Size	Outside Diameter	Inside Diameter	Wall Thickness	Length ( E )	Pipe Schedule	Approximate Weight (in Lbs.)
KC.5	½	0.84	0.622	0.109	1.00	40	0.08
KC.75	¾	1.05	0.824	0.113	1.25	40	0.14
KC1	1	1.32	1.049	0.133	1.50	40	0.21
KC1.25	1 ¼	1.66	1.380	0.140	1.50	40	0.33
KC1.5	1 ½	1.90	1.610	0.145	1.50	40	0.54
KC2	2	2.38	2.067	0.154	1.50	40	0.8
KC2.5	2 ½	2.88	2.469	0.203	1.50	40	1
KC3	3	3.50	3.068	0.216	2.00	40	1.7
KC3.5	3 ½	4.00	3.548	0.226	2.50	40	2.3
KC4	4	4.50	4.026	0.237	2.50	40	2.8
KC5	5	5.56	5.047	0.258	3.00	40	4.6
KC6	6	6.62	6.065	0.280	3.50	40	6.9
KC8	8	8.62	7.981	0.322	4.00	40	11.8
KC10	10	10.75	10.020	0.365	5.00	40	20.8
KC12	12	12.75	12.000	0.375	6.00	ST*	30.3
KC14	14	14.00	13.250	0.375	6.50	30	36.5
KC16	16	16.00	15.250	0.375	7.00	30	43.5
KC18	18	18.00	17.250	0.375	8.00	ST*	57
KC20	20	20.00	19.250	0.375	9.00	20	75.7
KC22	22	22.00	21.250	0.375	10.00	ST*	86
KC24	24	24.00	23.250	0.375	10.50	20	101
KC26	26	26.00	25.250	0.375	10.50	ST*	110
KC30	30	30.00	29.250	0.380	10.50	ST*	137
KC34	34	34.00	33.250	0.380	10.50	ST*	160
KC36	36	36.00	35.250	0.380	10.50	ST*	175
KC42	42	42.00	41.250	0.380	12.00	ST*	229
KC48	48	48.00	47.240	0.380	13.50	ST*	350

**\* ST\* designates Standard Weight (standard wall). This size and thickness does not correspond to any pipe schedule number.**

**\* Dimensions conform to ASME B16.9 & material conforms to ASTM SA-234 Grade B.**