

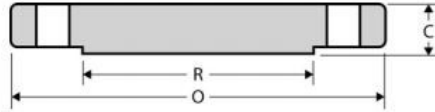

Blind Flange

CLASS 300, Carbon Steel

Inches / Pounds



Part #	Nominal Pipe Size	Outside Diam. of Flange (O)	Thick. of Flange (C)	Diam. of Raised Face (R)	No. of Bolt Holes	Diam. Of Bolt Holes	Diam. Of Bolts	Diam. Of Bolt Circle	Approx. Weight (in Lbs.)
K3FBL.5	1/2	3.75	0.56	1.38	4	0.62	0.50	2.62	2
K3FBL.75	3/4	4.62	0.62	1.69	4	0.75	0.62	3.25	3
K3FBL1	1	4.88	0.69	2.00	4	0.75	0.62	3.50	3
K3FBL1.25	1 1/4	5.25	0.75	2.50	4	0.75	0.62	3.88	4
K3FBL1.5	1 1/2	6.12	0.81	2.88	4	0.88	0.75	4.50	6
K3FBL2	2	6.50	0.88	3.62	8	0.75	0.62	5.00	8
K3FBL2.5	2 1/2	7.50	1.00	4.12	8	0.88	0.75	5.88	12
K3FBL3	3	8.25	1.12	5.00	8	0.88	0.75	6.62	16
K3FBL3.5	3-1/2	9.00	1.19	5.50	8	0.88	0.75	7.25	21
K3FBL4	4	10.00	1.25	6.19	8	0.88	0.75	7.88	27
K3FBL5	5	11.00	1.38	7.31	8	0.88	0.75	9.25	35
K3FBL6	6	12.50	1.44	8.50	12	0.88	0.75	10.62	50
K3FBL8	8	15.00	1.62	10.62	12	1.00	0.88	13.00	81
K3FBL10	10	17.50	1.88	12.75	16	1.12	1.00	15.25	124
K3FBL12	12	20.50	2.00	15.00	16	1.25	1.12	17.75	185
K3FBL14	14	23.00	2.12	16.25	20	1.25	1.12	20.25	250
K3FBL16	16	25.50	2.25	18.50	20	1.38	1.25	22.50	295
K3FBL18	18	28	2.38	21	24	1.38	1.25	24.75	395
K3FBL20	20	30.5	2.5	23	24	1.38	1.25	27	505
K3FSO24	24	36	2.75	27.25	24	1.62	1.5	32	790

*** Dimensions conform to ANSI B16.5**
*** Material conforms to ASTM A/SA-105**