

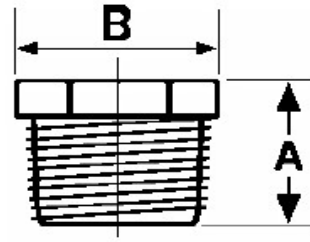

Hex Reducing Bushings

150# Malleable Iron, Galvanized

Inches / Pounds



Part #	Size	A	B	Approximate Weight (in Lbs.)	Hex
KHB.25X.125G	1/4 x 1/8	0.61	0.66	0.03	Out
KHB.375X.125G	3/8 x 1/8	0.81	0.73	0.05	Out
KHB.375X.25G	3/8 x 1/4	0.81	0.73	0.04	Out
KHB.5X.125G	1/2 x 1/8	0.95	0.88	0.09	Out
KHB.5X.25G	1/2 x 1/4	0.95	0.88	0.08	Out
KHB.5X.375G	1/2 x 3/8	0.95	0.88	0.07	Out
KHB.75X.125G	3/4 x 1/8	0.95	1.18	0.14	Out
KHB.75X.25G	3/4 x 1/4	1.05	1.18	0.15	Out
KHB.75X.375G	3/4 x 3/8	1.05	1.18	0.14	Out
KHB.75X.5G	3/4 x 1/2	1.05	1.18	0.12	Out
KHB1X.125G	1 x 1/8	1.12	1.15	0.19	In
KHB1X.25G	1 x 1/4	1.12	1.15	0.19	In
KHB1X.375G	1 x 3/8	1.16	1.15	0.23	In
KHB1X.5G	1 x 1/2	1.16	1.40	0.22	Out
KHB1X.75G	1 x 3/4	1.18	1.40	0.18	Out
KHB1.25X.125G	1 1/4 x 1/8	1.16	1.15	0.32	In
KHB1.25X.25G	1 1/4 x 1/4	1.16	1.15	0.27	In
KHB1.25X.375G	1 1/4 x 3/8	1.20	1.15	0.25	In
KHB1.25X.5G	1 1/4 x 1/2	1.25	1.38	0.34	In
KHB1.25X.75G	1 1/4 x 3/4	1.25	1.80	0.38	Out
KHB1.25X1G	1 1/4 x 1	1.25	1.80	0.30	Out
KHB1.5X.125G	1 1/2 x 1/8	1.30	1.18	0.45	In
KHB1.5X.25G	1 1/2 x 1/4	1.30	1.18	0.38	In
KHB1.5X.375G	1 1/2 x 3/8	1.30	1.18	0.39	In
KHB1.5X.5G	1 1/2 x 1/2	1.30	1.40	0.42	In
KHB1.5X.75G	1 1/2 x 3/4	1.30	1.66	0.45	In
KHB1.5X1G	1 1/2 x 1	1.30	1.95	0.47	Out
KHB1.5X1.25G	1 1/2 x 1 1/4	1.30	1.95	0.31	Out
KHB2X.25G	2 x 1/4	1.40	1.18	0.64	In
KHB2X.375G	2 x 3/8	1.40	1.18	0.63	In
KHB2X.5G	2 x 1/2	1.50	1.37	0.55	In
KHB2X.75G	2 x 3/4	1.50	1.68	0.60	In
KHB2X1G	2 x 1	1.50	1.97	0.65	In
KHB2X1.25G	2 x 1 1/4	1.50	2.55	0.81	Out
KHB2.1.5G	2 x 1 1/2	1.50	2.55	0.66	Out
KHB2.5X.5G	2 1/2 x 1/2	1.70	3.25	1.60	Out

Pipe Fitting Direct
 690 Craig Rd
 Edgerton, WI 53534
 Phone: (608) 371-9313
 Email: sales@pipefittingdirect.com

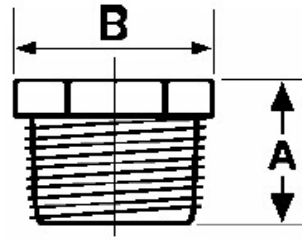

	Size	A	B	Approximate Weight (in Lbs.)	Hex
KHB2.5X.75G	2½ x ¾	1.58	1.65	0.82	In
KHB2.5X1G	2½ x 1	1.58	2.00	0.90	In
KHB2.5X1.25G	2½ x 1¼	1.58	2.40	1.00	In
KHB2.5X1.25G	2½ x 1½	1.58	2.70	1.06	In
KHB2.5X2G	2½ x 2	1.65	3.00	0.98	Out
KHB3X1.5G	3 x ½	1.88	3.80	2.10	Out
KHB3X.75G	3 x ¾	1.75	1.70	1.48	In
KHB3X1.5G	3 x 1	1.70	2.00	1.44	In
KHB3X1.25G	3 x 1¼	1.70	2.40	1.40	In
KHB3X1.5G	3 x 1½	1.70	2.70	1.44	In
KHB3X2G	3 x 2	1.80	3.70	2.20	Out
KHB3.2X5G	3 x 2½	1.90	3.90	1.82	Out
KHB3.5X1.5G	3½ x 1½	1.75	2.75	2.10	In
KHB3.5X2G	3½ x 2	1.94	1.80	2.16	In
KHB3.5X2.5G	3½ x 2½	1.70	4.30	2.50	Out
KHB3.5X3G	3½ x 3	1.75	4.60	2.10	Out
KHB4X.5G	4 x ½	2.00	4.80	4.30	Out
KHB4X.75G	4 x ¾	2.00	2.00	2.30	In
KHB4X1G	4 x 1	1.90	2.00	2.34	In
KHB4X1.25G	4 x 1¼	1.90	2.40	2.24	In
KHB4X1.5G	4 x 1½	1.90	2.70	2.10	In
KHB4X2G	4 x 2	1.90	3.30	2.74	In
KHB4X2.5G	4 x 2½	2.10	4.70	3.84	In
KHB4X3G	4 x 3	2.10	4.70	3.20	Out
KHB4X3.5G	4 x 3½	2.33	4.75	2.92	Out
KHB5X2G	5 x 2	2.05	3.30	4.26	In
KHB5X2.5G	5 x 2½	2.10	4.00	4.55	In
KHB5X3G	5 x 3	2.10	4.70	4.95	In
KHB5X4G	5 x 4	2.10	5.80	4.36	Out
KHB6X1.5G	6 x 1½	2.20	3.35	6.74	In
KHB6X2G	6 x 2	2.20	3.35	6.00	In
KHB6X2.5G	6 x 2½	2.20	3.90	6.58	In

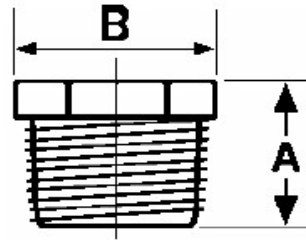

	Size	A	B	Approximate Weight (in Lbs.)	Hex
KHB6X3G	6 x 3	2.30	4.70	6.32	In
KHB6X4G	6 x 4	2.30	5.90	6.78	In
KHB6X5G	6 x 5	2.50	7.20	7.28	Out
KHB8X6G	8 x 6	2.75	9.00	16.40	Out

****Malleable Castings conform to ASTM A197***

****Malleable Bushings, Plugs and Locknuts conform to ASME B16.14***

****NPT Threads on all fittings conform to ASME B1.20.1***

****Class 150 fittings are UL listed and FM approved at 300 psi***

****Hot-Dipped Galvanization conforms to ASTM A153***