

# Threaded Crosses

## Lead Free Bronze, Class 125

### Inches / Pounds

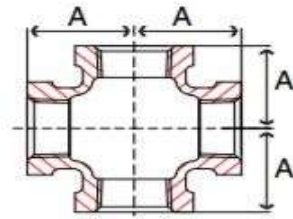

Part #	Size	Center to End (A)	Approximate Weight (in Lbs.)
KTC.25LB	1/4	0.71	0.2
KTC.375LB	3/8	0.82	0.2
KTC.5LB	1/2	1.01	0.5
KTC.75LB	3/4	1.18	0.8
KTC1LB	1	1.43	1.0
KTC1.25LB	1-1/4	1.69	1.6
KTC1.5LB	1-1/2	1.84	2.1
KTC2LB	2	2.12	3.3
KTC3LB	3	3.08	8.3

***\*Lead Free Bronze castings conform to ASTM B584, UNS Alloy C89833***

***\*Dimensions conform to ASME B16.15***

***\*NPT Threads on all fittings conform to ASME B1.20.1***

***\*Fittings conform to AWWA C800***

***\*Certified to ANSI/NSF 372, SWDA and California AB 1953***