

90° Elbows - Socket Weld
Class 3000
Forged Carbon Steel
 Inches / Pounds

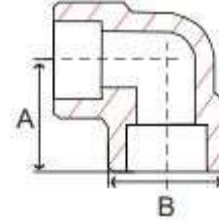

Part #	NPS Socket Size	Center to End (A)	Outside Diameter (B)	Approximate Weight (in Lbs.)
K3SW90E.125	1/8	0.82	0.68	0.2
K3SW90E.25	1/4	0.82	0.82	0.3
K3SW90E.375	3/8	0.91	0.98	0.2
K3SW90E.5	1/2	1.00	1.20	0.4
K3SW90E.75	3/4	1.25	1.41	0.7
K3SW90E1	1	1.38	1.74	1.1
K3SW90E1.25	1 1/4	1.56	2.10	1.8
K3SW90E1.5	1 1/2	1.75	2.36	2.3
K3SW90E2	2	2.12	2.89	3.7
K3SW90E2.5	2 1/2	2.24	3.54	7.0
K3SW90E3	3	2.87	4.21	11.8
K3SW90E4	4	3.37	5.30	24.1

****Forged Carbon Steel material conforms to ASTM SA105N, NORMALIZED***

****Socket weld inserts conform to MSS-SP-79***

****Dimensions conform to ASME B16.11***